



**Ford Mustang Qtr Window Louver  
Installation Instructions**

Application: 2005-07 Ford Mustang

**Before installing your Roush Performance Product(s), read through the entire installation procedure and check to make sure all items are present.**

**Packaging List for LH/RH Qtr Window Louver Kit # R03020124**

<b><u>Item</u></b>	<b><u>Quantity</u></b>
Louver, Qtr Window LH (#R03020116)	1
Louver, Qtr Window RH (#R03020117)	1
Hardware Kit (#R03020119)	2
Bracket, Front Attachment	2
Bracket, Rear Attachment	1
U-Nut, 8-32	3
Screw, 8-32x1/4	3
PT1100 Tape, 12x25mm 1.1 mm thk.	2
PT1100 Tape, 25x30mm 1.1 mm thk.	2
PT1500 Tape, 12x25mm 1.5 mm thk.	5
Template, Bracket Locating RH (#R03020125)	1
Template, Bracket Locating LH (#R03020126)	1
Installation Instructions (#R03020121)	1



Screw, 8-32x1/4



Rear Bracket

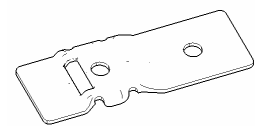

Front Bracket

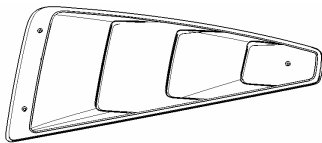

Right Louver #R03020117

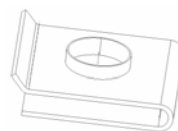

U-Nut

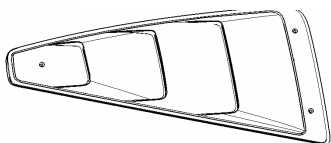

Left Louver #R03020116

PT1100 12x25 1.1 mm thick x 2  
 PT1500 12x25 1.5 mm thick x 5  
 PT1100 25x30 1.1 mm thick x 2



Tape

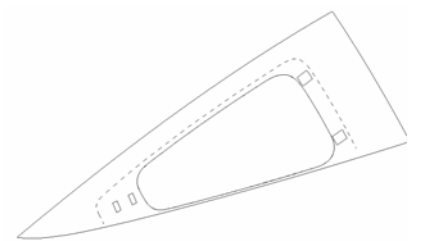

Template, Bracket Locating  
RH/LH  
#R03020125/#R03020126



### **Equipment and Supplies Required**

5/64in Hex Wrench  
Soft Cloth  
Rubbing Alcohol  
Roll of Masking Tape  
Torque Gage (N-m)

### **Suggested Materials**

Dupont® 2319 Plastic Prep  
Dupont® 2330S or equivalent Adhesion Promoter (for paint)  
3M 4298 Adhesion Promoter (for double-sided tape)

## **LIMIT OF LIABILITY STATEMENT**

The information contained in this publication was accurate and in effect at the time the publication was approved for printing and is subject to change without notice or liability. Roush Performance Products (RPP) reserves the right to Revise the information presented herein or to discontinue the Production of parts described at any time.

## **1. SAFETY REQUIREMENTS**

**STOP! READ IMPORTANT SAFETY CAUTIONS AND WARNINGS BEFORE PROCEEDING.**

### **IMPORTANT SAFETY NOTICE**

Appropriate disassembly, assembly methods and procedures are essential to ensure the personal safety of the individual performing the kit installation. Improper installation due to the failure to correctly follow these instructions could cause personal injury or death. Read each step of the installation manual carefully before starting the actual installation.

1. Always wear safety glasses for eye protection.
2. Place ignition switch in the OFF position.
3. Always apply the parking brake when working on a vehicle.
4. Block the front and rear tire surface to prevent unexpected vehicle movement.
5. Operate the engine only in well-ventilated areas to avoid exposure to carbon monoxide.
6. Do not smoke or use flammable items near or around the fuel system.



7. Use chemicals and cleaners in well-ventilated areas.
8. Batteries produce explosive gases, which can cause personal injury. Therefore, do not allow flames, sparks or flammable substances to come near the battery.
9. Keeps hands and any other objects away from the radiator fan blades.
10. Keep yourself and your clothing away from moving parts when the engine is running.
11. Do not wear loose clothing or jewelry that can get caught in rotating parts or scratch surface finishes.

## 2. Paint Preparation

1. Wipe each part with plastic prep (Dupont® 2319 or equivalent).
2. Wipe entire part with tack cloth.
3. Clean quarter glass and painted surface around quarter window with rubbing alcohol.

## 3. Pre-Installation

1. Wear eye protection.
2. Thoroughly clean qtr window area prior starting installation.

## 4. Installation Preparation

1. Attach supplied tape to brackets by removing white paper covering and positioning to bracket surface. Once positioned correctly, apply pressure to secure. Next install U-Nut to complete bracket assembly (see Figure A).

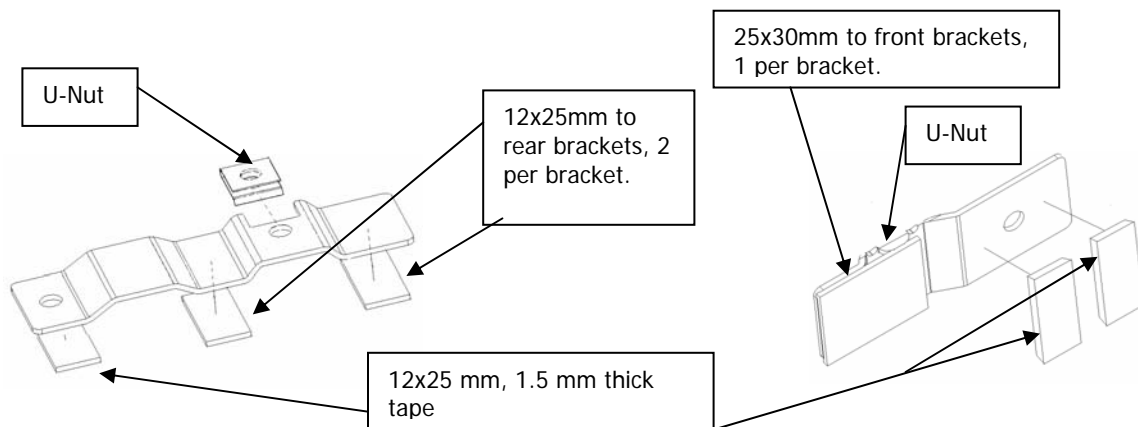

(Figure A)



## 5. Installation of Louver Brackets to Vehicle

1. Attach bracket template to vehicle by first aligning top roof tangent and door pillar tangent (Figure B). Refer to alignment marks on Template.

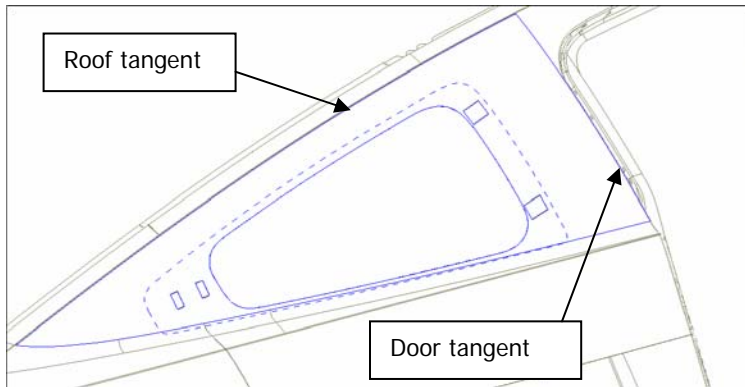

(Figure B)

2. Once template is located and taped down, remove red covering from tape on bracket assemblies and attached to vehicle. Align holes of bracket with hole locations on template; use bracket extension lines on template for further alignment aid (Figure C).

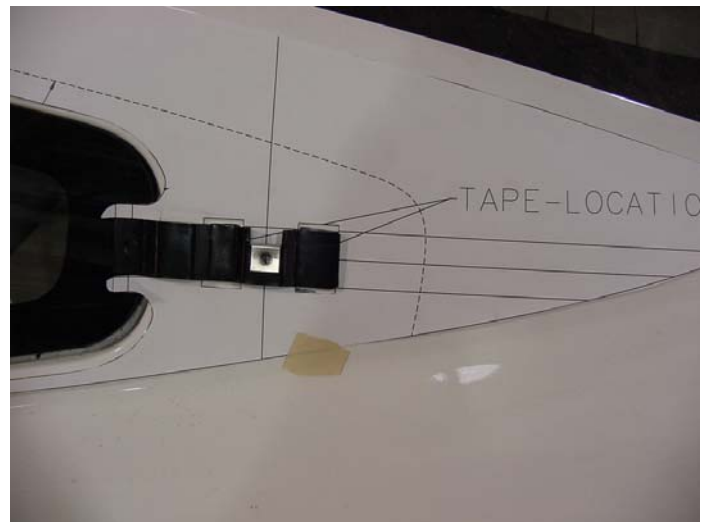

(Figure C)



3. Once brackets are positioned correctly to the template, apply pressure to brackets to thoroughly adhere the tape.
4. Allow tape to cure for **one hour** before installing louvers.
5. Remove louver template

## 6. Installation of Louver to Vehicle

1. Position Louver onto brackets and into position.
2. Insert supplied screw into Louver and thread into bracket u-nuts (**1 - 1.5 N-m Torque**).
3. Repeat installation procedure for opposite quarter window louver.
4. Quarter window louver installation is complete (see Figure D).



**Figure D**



**Note:** If items are missing or for any questions regarding the installation of this kit, please contact Roush Performance toll free at 1-800-59-ROUSH.

## **WARRANTY**

All retail parts carry a 90-day warranty from the date of purchase. This warranty covers defects in materials or workmanship, and does not include (i) normal wear and tear, environmental conditions, improper installation; (ii) road hazards, misuse, abuse, neglect, accidents, collision, fire, theft, freezing, vandalism, riot, explosion, or objects striking the vehicle; (iii) misusing the vehicle, such as driving over curbs, overloading, racing, or using the vehicle as a stationary power source; (iv) altering, disassembling or modifying the parts; (v) defects caused or induced by failures, breakdowns, or damage by other parts, components or the vehicle; (vi) subjecting the parts to excessive moisture or water or any motor vehicle fluids (e.g.: oil, anti-freeze, battery acid, brake fluid, etc.); (vii) acts of God, natural disasters and other similar causes beyond the reasonable control of Roush; or (viii) application of chemicals that affect the parts. This Limited Warranty does not cover surface deterioration of paint, trim, and appearance items that result from use and/or exposure to the elements, such as stone chips, scratches, bird droppings, lightning, hail, windstorm, dings, dents, earthquake, road salt, tree sap, water or flood.

ROUSH SHALL NOT BE LIABLE TO REIMBURSE CUSTOMER/DEALER FOR INCIDENTAL OR CONSEQUENTIAL DAMAGES RESULTING FROM THE INSTALLATION OR USE OF ANY PRODUCT SOLD THROUGH THIS CATALOG OR ARISING OUT OF ANY BREACH OF WARRANTY. EXCEPT AS MAY BE STATED IN THIS CATALOG, ROUSH DISCLAIMS ALL EXPRESS AND IMPLIED WARRANTIES, INCLUDING THE WARRANTIES OF MERCHANTABILITY AND FITNESS FOR A PARTICULAR PURPOSE. IN NO EVENT SHALL ROUSH'S LIABILITY EXCEED THE PRICE PAID BY CUSTOMER/DEALER FOR PRODUCTS SOLD REGARDLESS IF ROUSH HAS BEEN ADVISED IN ADVANCE OF ANY POTENTIAL PROBLEM OR IF A CLAIM IS BASED ON CONTRACT, TORT, STRICT LIABILITY, PRODUCT LIABILITY OR OTHERWISE. SOME STATES DO NOT ALLOW THE EXCLUSION OR LIMITATION OF IMPLIED WARRANTIES OR THEIR DURATION, OR LIABILITY FOR INCIDENTAL OR CONSEQUENTIAL DAMAGES, SO THE ABOVE EXCLUSIONS OR LIMITATIONS MAY NOT APPLY.