

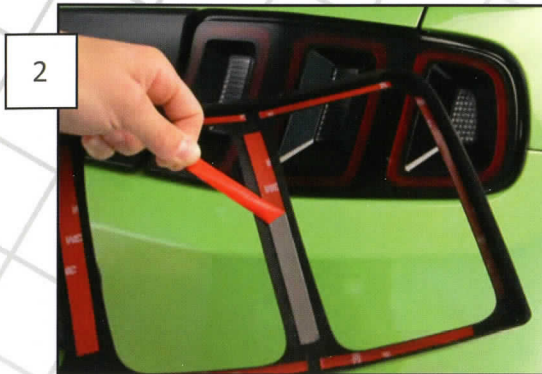

## 2013 Tail Light Trim



Before beginning, thoroughly clean the tail light lens to make sure they are free of any dirt or contaminants.



2 Peel the backing from the 3M tape as shown above.



4 Once the trim is properly located, firmly press down to fully seat the adhesive tape.



1 Use the supplied alcohol pads to thoroughly wipe down the areas where the adhesive tape from the tail light trim will contact the light.

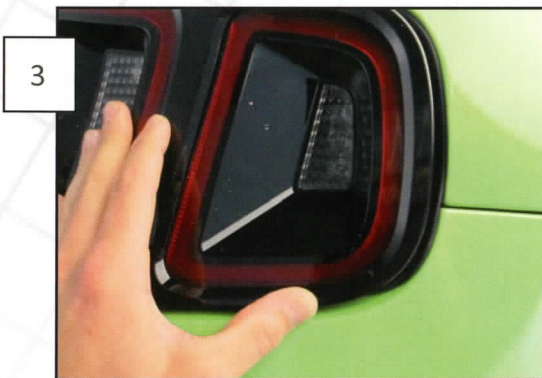

3 Beginning with the outside edge, carefully place the trim over the tail light, making sure to align the edges of the trim with the edges of the LED surrounds on the light. Do not press down at this point to fully seat the adhesive.

5 Repeat Steps 1-4 for opposite side trim to complete the installation.